

- GENERAL**
- THE CONTRACTOR IS TO VERIFY THE LOCATION AND DEPTH OF ALL UTILITY SERVICES PRIOR TO CARRYING OUT WORKS BY TELEPHONING 1100 'DIAL BEFORE YOU DIG'.
 - DISCREPANCIES BETWEEN PLANS AND EXISTING CONDITIONS ARE TO BE REPORTED IMMEDIATELY TO THE COUNCIL'S SUPERVISING ENGINEER.
 - ALL SURPLUS EXCAVATED MATERIAL REMAINS THE PROPERTY OF THE CONTRACTOR UNLESS SPECIFIED OTHERWISE OR ADVISED BY THE COUNCIL'S SUPERVISING ENGINEER.
 - "REMOVE" SHALL MEAN REMOVE OFF-SITE AND DISPOSE OF AT AN APPROVED DISPOSAL SITE AT THE CONTRACTOR'S EXPENSE, UNLESS SPECIFIED OTHERWISE.
 - ON COMPLETION OF CONSTRUCTION ALL WORK AREA ARE TO BE CLEANED UP & REINSTATED TO THE SATISFACTION OF THE COUNCIL'S SUPERVISING ENGINEER.
- PAVEMENT**
- ROAD CROSSFALL TO BE 1 in 36 FALLING TOWARDS THE TABLE DRAIN OR KERB AND CHANNEL UNLESS SPECIFIED OTHERWISE.
 - AT NEW FILL AREAS THE TOPSOIL SHALL BE STRIPPED AND FILLING MATERIAL PLACED IN 150mm THICK LAYER AND COMPACTED TO 95% A.A.S.H.O. COMPACTION TEST, THE TOPSOIL IS THEN RE-SPREAD ON THE BATTER AREAS.
 - NEW CONCRETE FOOTPATH PAVING TO BE 32 MPa STRENGTH.
 - TACTILE GROUND SURFACE INDICATOR (TGSi) PAVERS ARE TO BE 300mm x 300mm x 40mm PRE-CAST CONCRETE PAVERS AND SHALL HAVE A MINIMUM LUMINANCE CONTRAST OF 30% COMPARED TO THE AMOUNT OF LIGHT REFLECTED FROM THE ADJACENT SURFACE.
- ROADSIDE**
- EXISTING DRIVEWAY ENTRANCES TO BE REINSTATED AND SEALED FOR 1.0m FROM EDGE OF SEAL WITH 50mm COMPACTED DEPTH 10mm TYPE N ASPHALT ON A BASE OF 100mm COMPACTED DEPTH CLASS 2 FINE CRUSHED ROCK.
 - EXISTING DRIVEWAYS ARE TO BE REINSTATED FROM BACK OF KERB OR EDGE OF SEAL AT A MAXIMUM GRADE OF 1 in 8 FOR 2.0m THEN 1 in 4 THEREAFTER WITH A TRANSITION OF 1 in 6 FOR 2.0m IS PREFERRED WHERE POSSIBLE AS PER:
 - GRAVEL DRIVEWAY WITH 50mm COMPACTED DEPTH OF 3% CEMENT TREATED CRUSHED ROCK UNLESS SPECIFIED OTHERWISE.
 - ASPHALT DRIVEWAYS WITH 50mm COMPACTED DEPTH 10mm NOMINAL SIZE ASPHALT ON A BASE OF 100mm COMPACTED DEPTH CLASS 2 FINE CRUSHED ROCK.
 - CONCRETE DRIVEWAYS WITH 150mm DEPTH CONCRETE PAVING ON A BASE OF 50mm COMPACTED DEPTH CLASS 2 FINE CRUSHED ROCK.
 - BRICK PAVEMENT DRIVEWAYS WITH SUITABLE HEAVY DUTY BRICK PAVERS ON 30mm OF BEDDING SAND ON A BASE OF 100mm COMPACTED DEPTH CLASS 2 FINE CRUSHED ROCK.
 - TABLE DRAIN TO BE CLEANED, REDEFINED OR DEFINED AS NECESSARY ALONG THE HIGH SIDE OF THE ROADWAY, REFER TO TYPE OF SECTION FOR TABLE DRAIN PROFILE, MINIMUM DEPTH 300mm.

ROAD & DRAINAGE RECONSTRUCTION WORKS

MILLER STREET & MONTPELLIER STREET, HEALESVILLE



WARNING
BEWARE OF UNDERGROUND SERVICES
THE LOCATION OF EXISTING UNDERGROUND SERVICES ARE APPROXIMATE ONLY AND THEIR EXACT POSITION SHOULD BE PROVEN ON SITE. NO GUARANTEE IS GIVEN THAT ALL EXISTING SERVICES ARE SHOWN.

DRAWING INDEX

SHEET No.	TITLE
1	TITLE SHEET - LOCALITY PLAN, GENERAL NOTES, DRAWING INDEX & DETAILS
2	OVERALL PLAN
3	TYPICAL SECTIONS A-A, B-B & C-C
4	TYPICAL SECTIONS D-D, E-E, F-F, G-G, H-H & I-I
5	GENERAL LAYOUT PLAN
6	GENERAL LAYOUT PLAN
7	SWEPT PATH ANALYSIS PLAN - YRSC WASTE VEHICLE
8	SWEPT PATH ANALYSIS PLAN - STANDARD B85 VEHICLE

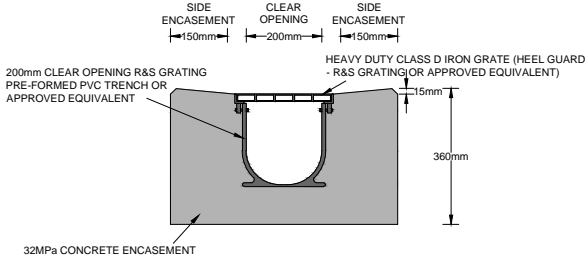

TRENCH GRATE DETAIL

ADAPTED FROM R&S GRATING - TRENCH GRATING - QUICK INSTALL GUIDELINES

NOT TO SCALE

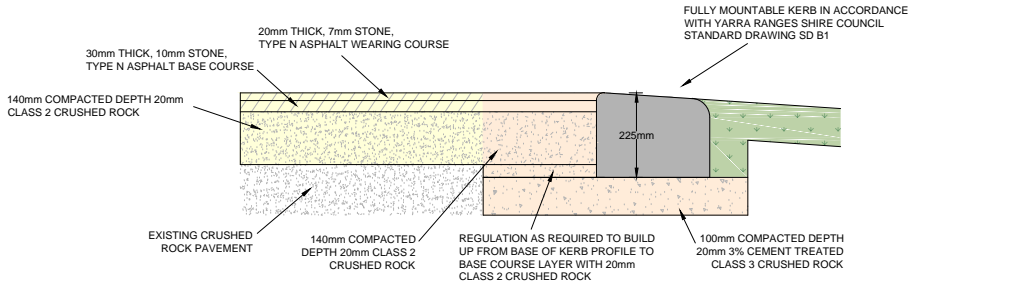

FULLY MOUNTABLE KERB DETAIL

GENERALLY IN ACCORDANCE WITH YARRA RANGES SHIRE COUNCIL DRAWING SD / D5

NOT TO SCALE

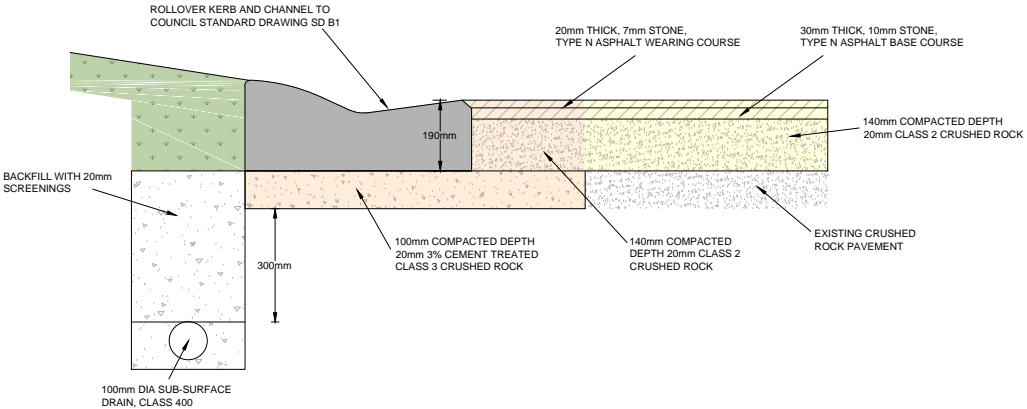

ROLLOVER KERB AND CHANNEL DETAIL

GENERALLY IN ACCORDANCE WITH YARRA RANGES SHIRE COUNCIL DRAWING SD / D5

NOT TO SCALE

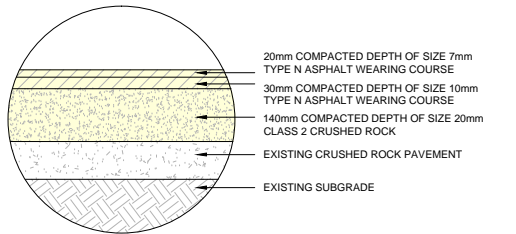

OVERLAY EXISTING PAVEMENT DETAIL

NOT TO SCALE

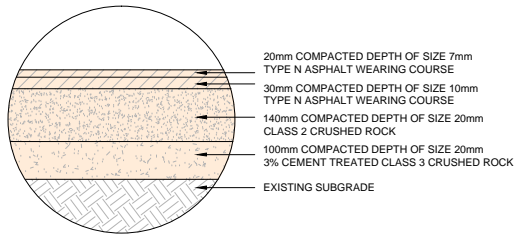

FULL DEPTH PAVEMENT DETAIL

NOT TO SCALE

VER	DESCRIPTION	DATE
02	FUNCTIONAL DESIGN - ISSUED FOR REVIEW	07-10-2021
01	FUNCTIONAL DESIGN - ISSUED FOR REVIEW	30-09-2021
00	FUNCTIONAL DESIGN - ISSUED FOR REVIEW	30-04-2021

CONSULTANT ENGINEER

PROCIVIL
CONSULTING ENGINEERING

Specialist Civil Engineering Design Consultants

Commitment | Communication | Collaboration

PROCIVIL CONSULTING PTY LTD
ABN 51 759 386 082
SUITE 9, 12 MAROONDHA HWY, RINGWOOD VIC 3134
PO BOX 164, RINGWOOD VIC 3134
P: (03) 8644 6834
E: info@procivil.com.au
www.procivil.com.au

CIVIL ENGINEERING DESIGN
KURT CHAMBERLAIN

TECHNICAL PEER REVIEW
LUKE WHITFIELD

REGISTERED & CHARTERED PROFESSIONAL ENGINEER
CHRIS PROCTOR

ORIENTATION

OR AS SHOWN

ORIGINAL SCALE & SHEET SIZE
AS SHOWN @ A1

HEIGHT DATUM
AHD

COORDINATE DATUM
MGA 94 ZONE 55

SURVEY DATE
18-09-2020

AERIAL IMAGE DATE
12-12-2020

LOCAL GOVERNMENT AREA
SHIRE OF YARRA RANGES

CLIENT

CLIENT PROJECT MANAGER / CONTACT
PETROS INDOS | GRANT MCCARTHY

FUNCTIONAL DESIGN

ROAD & DRAINAGE RECONSTRUCTION WORKS

MILLER STREET & MONTPELLIER STREET, HEALESVILLE

TITLE SHEET - LOCALITY PLAN, GENERAL NOTES, DRAWING INDEX & DETAILS

PROJECT No.
PC20009B

SHEET No.
01 OF 08

VERSION
02

DWG No.
PC20009B - 01-02



WARNING
BEWARE OF UNDERGROUND SERVICES.
THE LOCATION OF EXISTING UNDERGROUND SERVICES ARE APPROXIMATE
ONLY AND THEIR EXACT POSITION SHOULD BE PROVEN ON SITE. NO
GUARANTEE IS GIVEN THAT ALL EXISTING SERVICES ARE SHOWN.

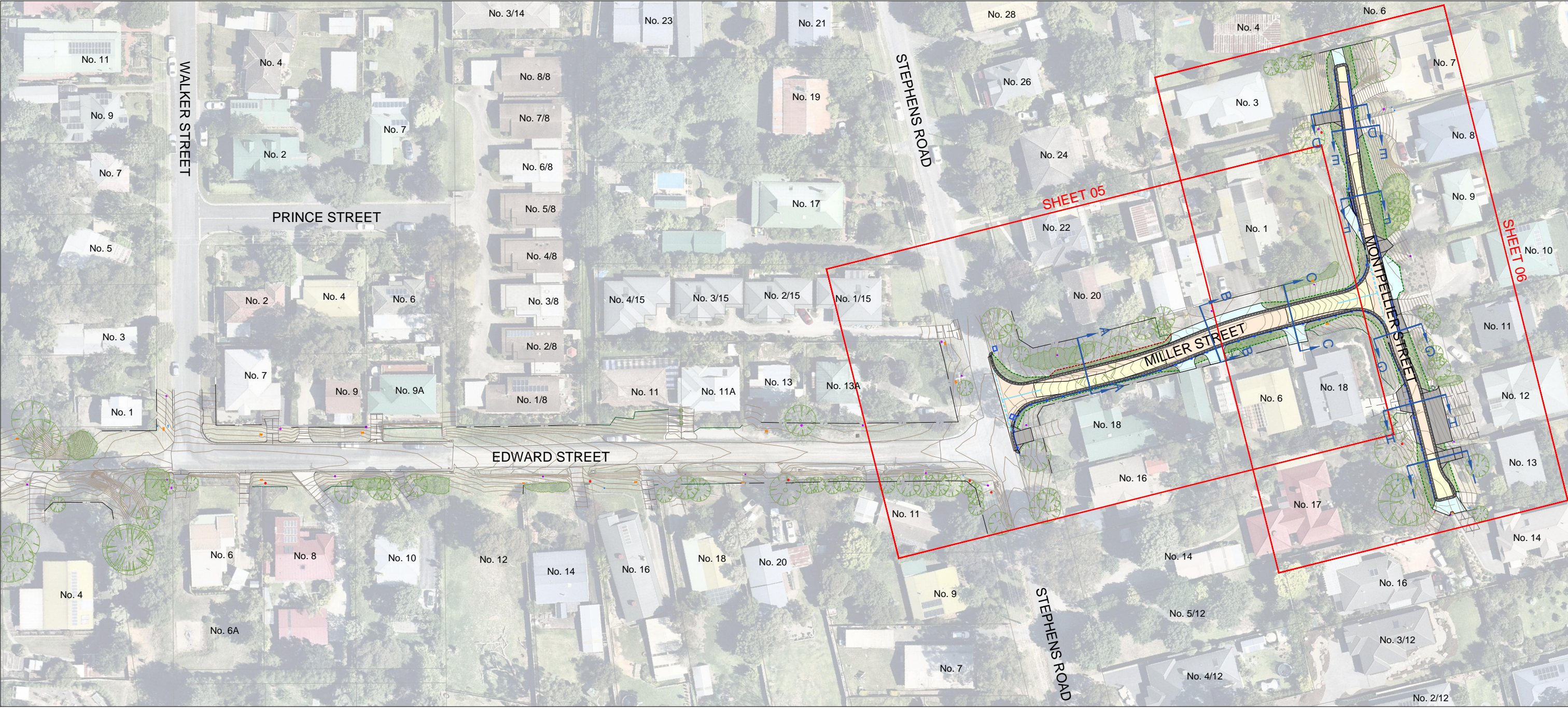

OVERALL PLAN

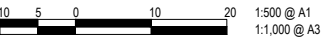

VER	DESCRIPTION	DATE
02	FUNCTIONAL DESIGN - ISSUED FOR REVIEW	07-10-2021
01	FUNCTIONAL DESIGN - ISSUED FOR REVIEW	30-09-2021
00	FUNCTIONAL DESIGN - ISSUED FOR REVIEW	30-04-2021

CONSULTANT ENGINEER

PROCIVIL
CONSULTING ENGINEERING

Specialist Civil Engineering Design Consultants

Commitment | Communication | Collaboration

PROCIVIL CONSULTING PTY LTD
ABN 51 759 386 092
SUITE 9, 12 MAROONDAH HWY, RINGWOOD VIC 31134
PO BOX 164, RINGWOOD VIC 31134
P: (03) 8644 6834
E: info@procivil.com.au
www.procivil.com.au

CIVIL ENGINEERING DESIGN KURT CHAMBERLAIN	TECHNICAL PEER REVIEW LUKE WHITFIELD
REGISTERED & CHARTERED PROFESSIONAL ENGINEER CHRIS PROCTOR	

ORIENTATION

OR AS SHOWN

ORIGINAL SCALE & SHEET SIZE
AS SHOWN @ A1

HEIGHT DATUM
AHD

COORDINATE DATUM
MGA 94 ZONE 55

SURVEY DATE
18-09-2020

AERIAL IMAGE DATE
12-12-2020

LOCAL GOVERNMENT AREA
SHIRE OF YARRA RANGES

CLIENT

CLIENT PROJECT MANAGER / CONTACT
PETROS INDOS | GRANT MCCARTHY

FUNCTIONAL DESIGN

ROAD & DRAINAGE RECONSTRUCTION WORKS

MILLER STREET & MONTPELLIER STREET, HEALESVILLE

OVERALL PLAN

PROJECT No.
PC20009B

SHEET No.
02 OF 08

VERSION
02

DWG No.
PC20009B - 02- 02



WARNING
BEWARE OF UNDERGROUND SERVICES
THE LOCATION OF EXISTING UNDERGROUND SERVICES ARE APPROXIMATE
ONLY AND THEIR EXACT POSITION SHOULD BE PROVEN ON SITE. NO
GUARANTEE IS GIVEN THAT ALL EXISTING SERVICES ARE SHOWN.

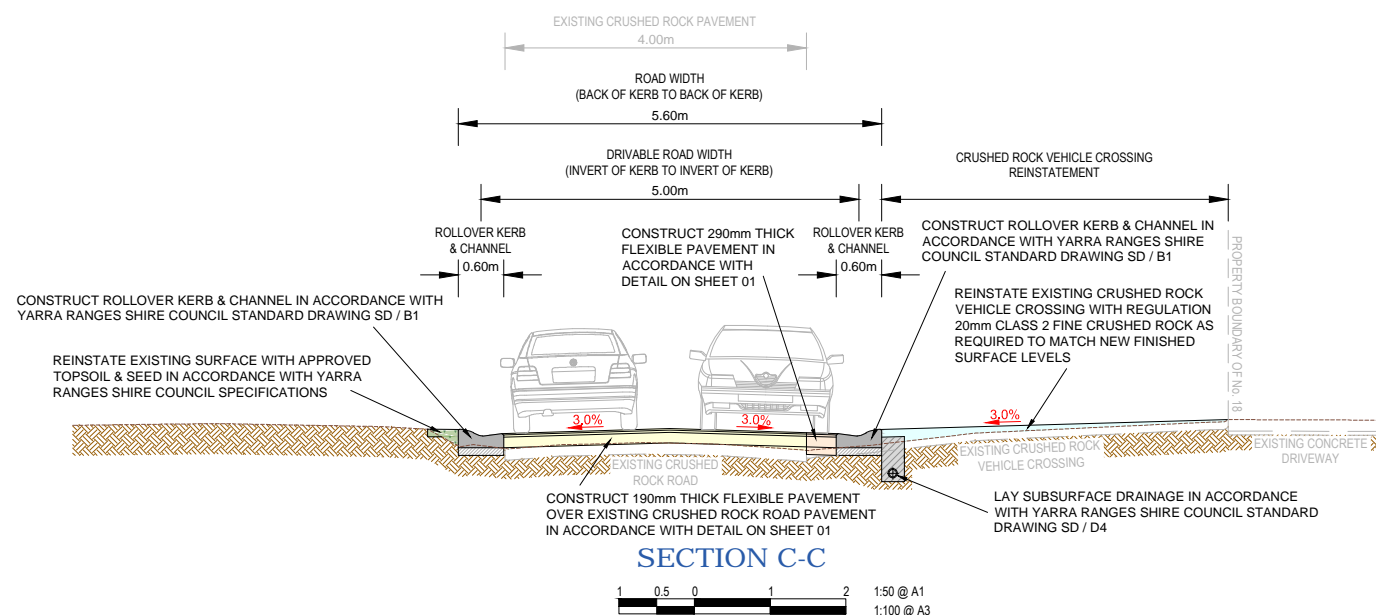
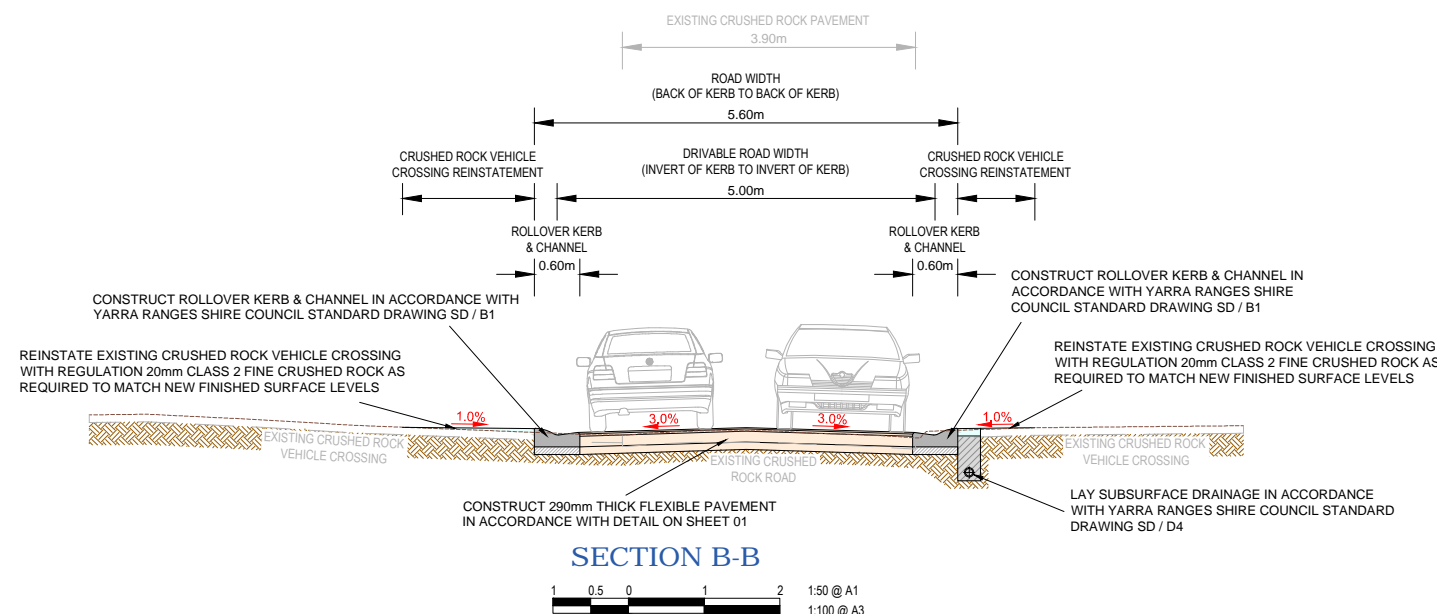
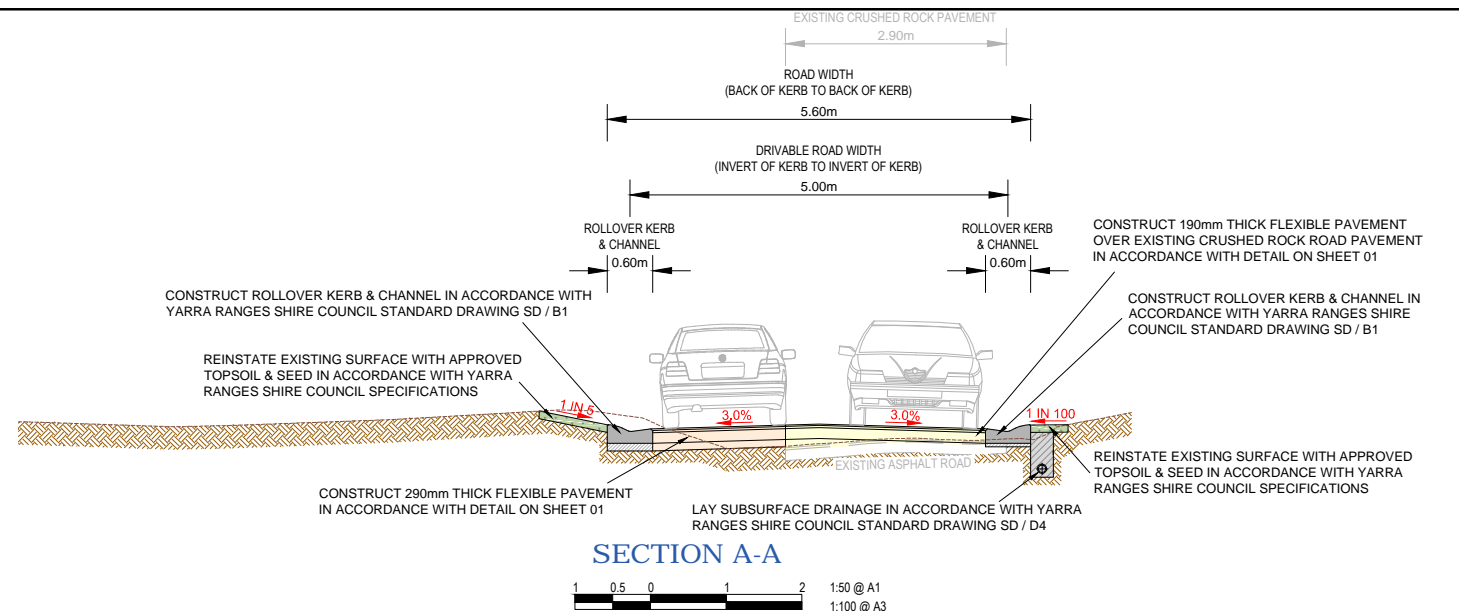

02	FUNCTIONAL DESIGN - ISSUED FOR REVIEW	07-10-2021
01	FUNCTIONAL DESIGN - ISSUED FOR REVIEW	30-09-2021
00	FUNCTIONAL DESIGN - ISSUED FOR REVIEW	30-04-2021
VER	DESCRIPTION	DATE

CONSULTANT ENGINEER

PROCIVIL
CONSULTING ENGINEERING

Specialist Civil Engineering Design Consultants

Commitment | Communication | Collaboration

PROCIVIL CONSULTING PTY LTD

ABN 51 759 386 092

SUITE 9, 12 MAROONDAH HWY, RINGWOOD VIC 31134

PO BOX 164, RINGWOOD VIC 31134

P: (03) 8644 6834

E: info@procivil.com.au

www.procivil.com.au

CIVIL ENGINEERING DESIGN

KURT CHAMBERLAIN

TECHNICAL PEER REVIEW

LUKE WHITFIELD

REGISTERED & CHARTERED PROFESSIONAL ENGINEER

CHRIS PROCTOR

ORIENTATION

OR AS SHOWN

ORIGINAL SCALE & SHEET SIZE

AS SHOWN @ A1

HEIGHT DATUM

AHD

COORDINATE DATUM

MGA 94 ZONE 55

SURVEY DATE

18-09-2020

AERIAL IMAGE DATE

12-12-2020

LOCAL GOVERNMENT AREA

SHIRE OF YARRA RANGES

CLIENT

CLIENT PROJECT MANAGER / CONTACT

PETROS INDOS | GRANT MCCARTHY

FUNCTIONAL DESIGN

ROAD & DRAINAGE RECONSTRUCTION WORKS

MILLER STREET & MONTPELLIER STREET, HEALESVILLE

TYPICAL SECTIONS A-A, B-B & C-C

PROJECT No.

PC20009B

SHEET No.

03 OF 08

VERSION

02

DWG No.

PC20009B - 03 - 02

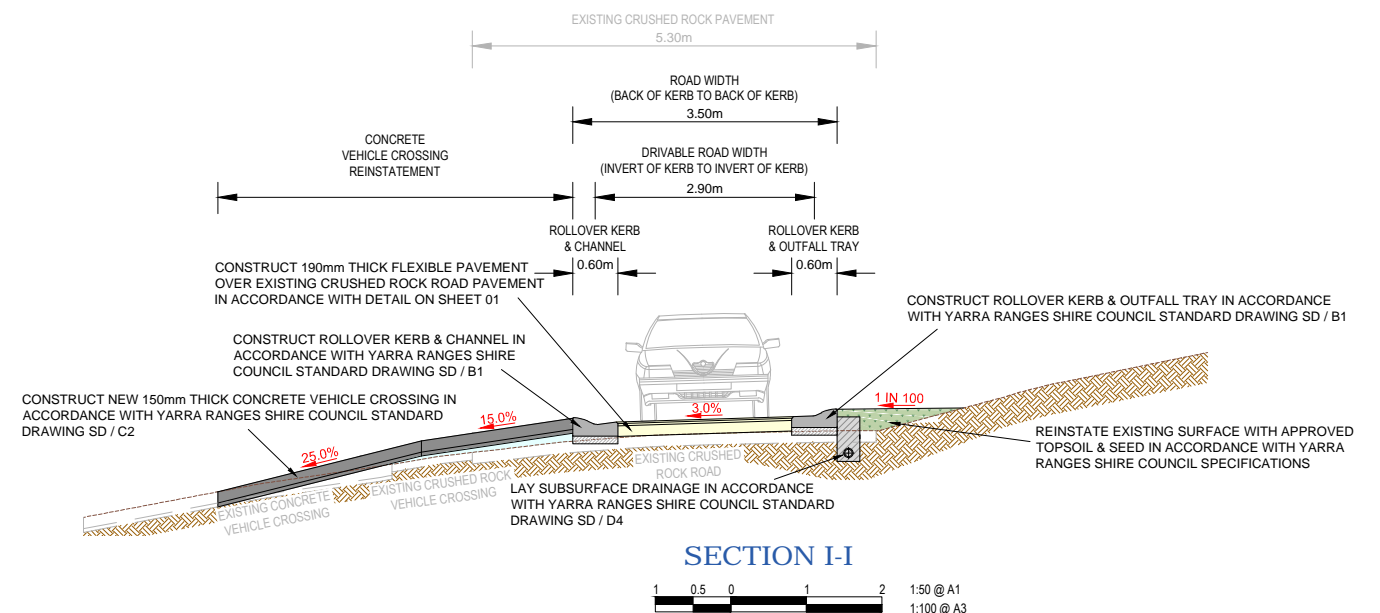
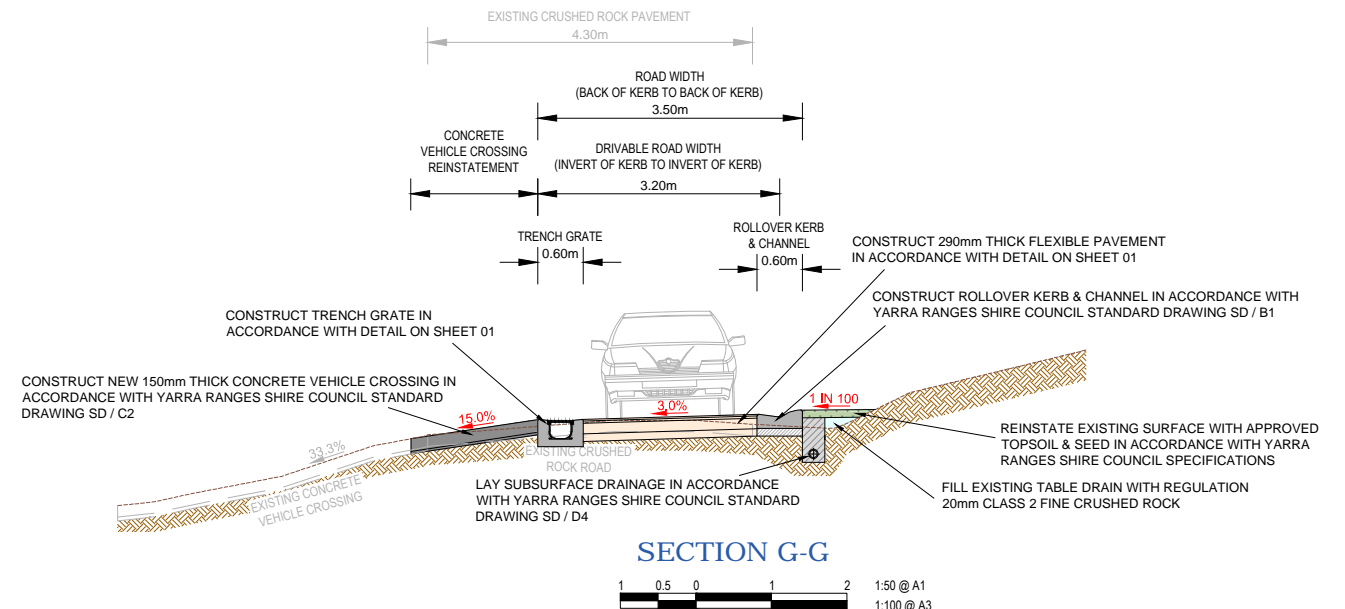
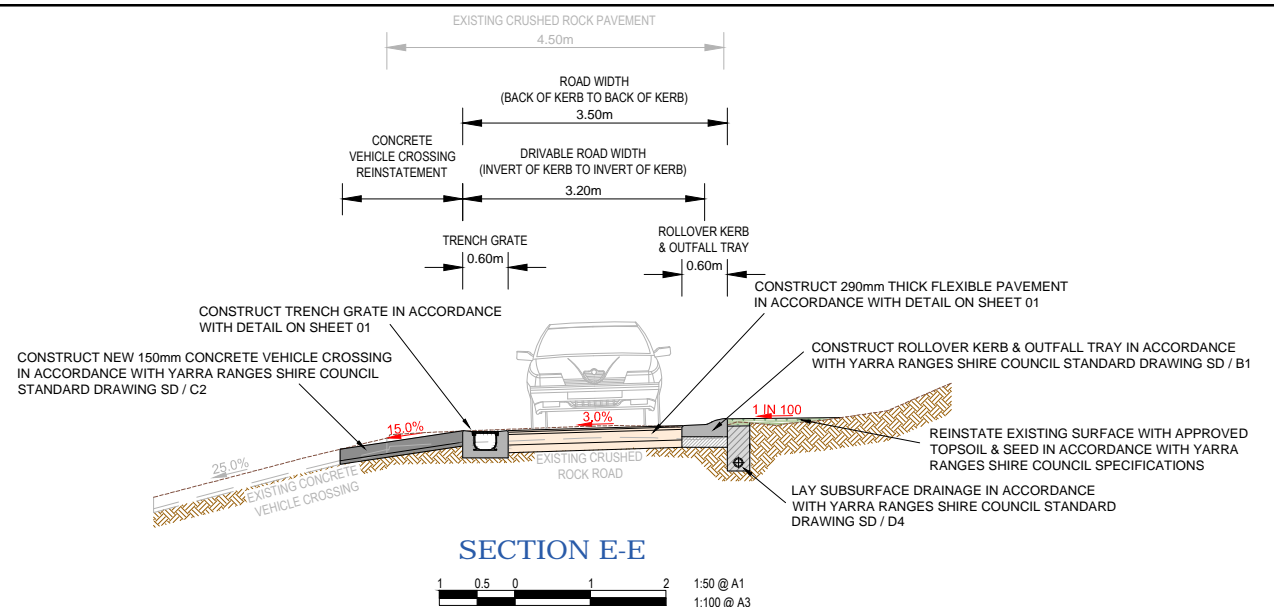
[illegible]

LEGEND

- OVERLAY EXISTING PAVEMENT - 190mm THICK FLEXIBLE PAVEMENT IN ACCORDANCE WITH DETAIL ON SHEET 01

FULL DEPTH PAVEMENT - 290mm THICK FLEXIBLE PAVEMENT IN ACCORDANCE WITH DETAIL ON SHEET 01

50mm THICK ASPHALT VEHICLE CROSSING - CONSTRUCTED IN GENERAL ACCORDANCE WITH YARRA RANGES SHIRE COUNCIL STANDARD DRAWING SD / C2

150mm THICK CONCRETE VEHICLE CROSSING - CONSTRUCTED IN GENERAL ACCORDANCE WITH YARRA RANGES SHIRE COUNCIL STANDARD DRAWING SD / C2

100mm MINIMUM THICKNESS CLASS 2 CRUSHED ROCK VEHICLE CROSSING - CONSTRUCTED IN GENERAL ACCORDANCE WITH YARRA RANGES SHIRE COUNCIL STANDARD DRAWING SD / C2
- LAWN AREA TO BE REINSTATED WITH YARRA RANGES SHIRE COUNCIL APPROVED TOPSOIL AND SEED

PROPOSED PAVEMENT GRADE

EXISTING DRAINAGE PIPE

NEW DRAINAGE PIT WITH PIT NUMBER AND PIPE

DIRECTION OF CHANNEL FLOW

SUBSURFACE DRAINAGE IN ACCORDANCE WITH YARRA RANGES SHIRE COUNCIL STANDARD DRAWING SD / D4

PAVEMENT LINE MARKING

NEW CONCRETE KERB AND CHANNEL IN ACCORDANCE WITH YARRA RANGES SHIRE COUNCIL STANDARD DRAWING SD / B1

NEW CONCRETE SLEEPER RETAINING WALL - CONSTRUCTED IN ACCORDANCE WITH YARRA RANGES SHIRE COUNCIL STANDARD DRAWING SD / F5
- EXISTING WATER

EXISTING GAS

EXISTING SEWER

EXISTING TELECOMMUNICATIONS

EXISTING UNDERGROUND ELECTRICITY

EXISTING CONTOUR MAJOR (1.0m)

EXISTING CONTOUR MINOR (0.2m)

FINISHED SURFACE CONTOUR MAJOR (1.0m)

FINISHED SURFACE CONTOUR MINOR (0.2m)

FILL BATTER EXTENT

CUT BATTER EXTENT

REMOVE EXISTING DRAINAGE PIPE

EXISTING TREE FOR REMOVAL



WARNING
BEWARE OF UNDERGROUND SERVICES
THE LOCATION OF EXISTING UNDERGROUND SERVICES ARE APPROXIMATE ONLY AND THEIR EXACT POSITION SHOULD BE PROVEN ON SITE. NO GUARANTEE IS GIVEN THAT ALL EXISTING SERVICES ARE SHOWN.

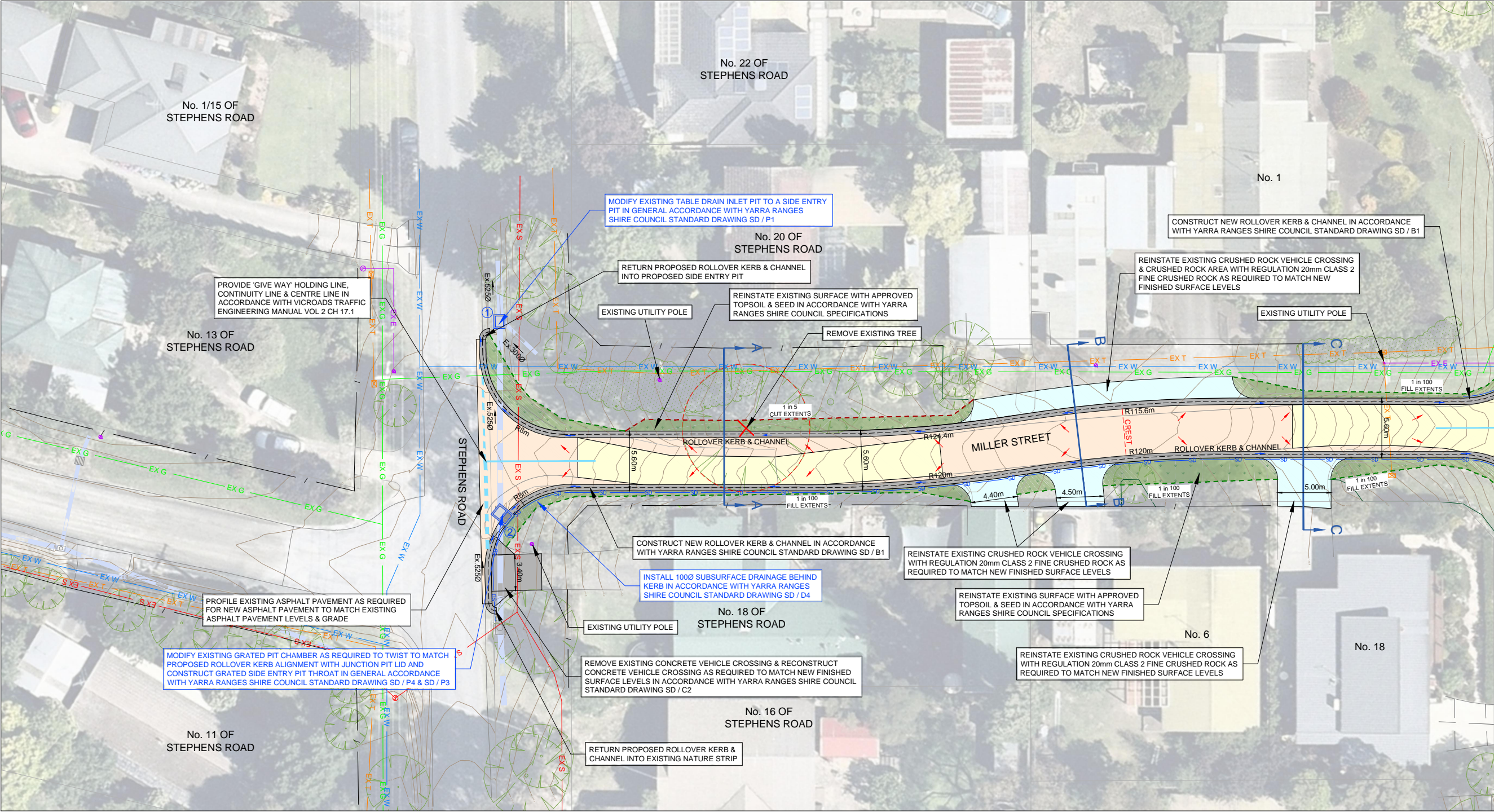

CONTINUED ON SHEET 06

GENERAL LAYOUT PLAN



VER	DESCRIPTION	DATE
02	FUNCTIONAL DESIGN - ISSUED FOR REVIEW	07-10-2021
01	FUNCTIONAL DESIGN - ISSUED FOR REVIEW	30-09-2021
00	FUNCTIONAL DESIGN - ISSUED FOR REVIEW	30-04-2021

CONSULTANT ENGINEER

PROCIVIL

CONSULTING ENGINEERING

Specialist Civil Engineering Design Consultants

Commitment | Communication | Collaboration

PROCIVIL CONSULTING PTY LTD

ABN 51 759 386 092

SUITE 9, 12 MAROONDAH HWY, RINGWOOD VIC 3134

PO BOX 164, RINGWOOD VIC 3134

P: (03) 8644 6834

E: info@procivil.com.au

www.procivil.com.au

CIVIL ENGINEERING DESIGN

KURT CHAMBERLAIN

REGISTERED & CHARTERED PROFESSIONAL ENGINEER

CHRIS PROCTOR

TECHNICAL PEER REVIEW

LUKE WHITFIELD

ORIENTATION

OR AS SHOWN

ORIGINAL SCALE & SHEET SIZE

AS SHOWN @ A1

HEIGHT DATUM

AHD

COORDINATE DATUM

MGA 94 ZONE 55

SURVEY DATE

18-09-2020

AERIAL IMAGE DATE

12-12-2020

LOCAL GOVERNMENT AREA

SHIRE OF YARRA RANGES

CLIENT

Yarra Ranges Council

CLIENT PROJECT MANAGER / CONTACT

PETROS INDOS | GRANT MCCARTHY

FUNCTIONAL DESIGN

ROAD & DRAINAGE RECONSTRUCTION WORKS

MILLER STREET & MONTPELLIER STREET, HEALESVILLE

GENERAL LAYOUT PLAN

PROJECT No.

PC20009B

SHEET No.

05 OF 08

VERSION

02

DWG No.

PC20009B - 05 - 02

LEGEND

- OVERLAY EXISTING PAVEMENT - 190mm THICK FLEXIBLE PAVEMENT IN ACCORDANCE WITH DETAIL ON SHEET 01

FULL DEPTH PAVEMENT - 290mm THICK FLEXIBLE PAVEMENT IN ACCORDANCE WITH DETAIL ON SHEET 01

50mm THICK ASPHALT VEHICLE CROSSING - CONSTRUCTED IN GENERAL ACCORDANCE WITH YARRA RANGES SHIRE COUNCIL STANDARD DRAWING SD / C2

150mm THICK CONCRETE VEHICLE CROSSING - CONSTRUCTED IN GENERAL ACCORDANCE WITH YARRA RANGES SHIRE COUNCIL STANDARD DRAWING SD / C2

100mm MINIMUM THICKNESS CLASS 2 CRUSHED ROCK VEHICLE CROSSING - CONSTRUCTED IN GENERAL ACCORDANCE WITH YARRA RANGES SHIRE COUNCIL STANDARD DRAWING SD / C2
- LAWN AREA TO BE REINSTATED WITH YARRA RANGES SHIRE COUNCIL APPROVED TOPSOIL AND SEED

PROPOSED PAVEMENT GRADE

EXISTING DRAINAGE PIPE

NEW DRAINAGE PIT WITH PIT NUMBER AND PIPE

DIRECTION OF CHANNEL FLOW

SUBSURFACE DRAINAGE IN ACCORDANCE WITH YARRA RANGES SHIRE COUNCIL STANDARD DRAWING SD / D4

PAVEMENT LINE MARKING

NEW CONCRETE KERB AND CHANNEL IN ACCORDANCE WITH YARRA RANGES SHIRE COUNCIL STANDARD DRAWING SD / B1

NEW CONCRETE SLEEPER RETAINING WALL - CONSTRUCTED IN ACCORDANCE WITH YARRA RANGES SHIRE COUNCIL STANDARD DRAWING SD / F5
- EX W

EXISTING WATER

EX G

EXISTING GAS

EX S

EXISTING SEWER

EX T

EXISTING TELECOMMUNICATIONS

EX E

EXISTING UNDERGROUND ELECTRICITY

46

EXISTING CONTOUR MAJOR (1.0m)

46

EXISTING CONTOUR MINOR (0.2m)

46

FINISHED SURFACE CONTOUR MAJOR (1.0m)

46

FINISHED SURFACE CONTOUR MINOR (0.2m)

FILL BATTER EXTENT

CUT BATTER EXTENT

REMOVE EXISTING DRAINAGE PIPE

EXISTING TREE FOR REMOVAL



WARNING
BEWARE OF UNDERGROUND SERVICES.
THE LOCATION OF EXISTING UNDERGROUND SERVICES ARE APPROXIMATE ONLY AND THEIR EXACT POSITION SHOULD BE PROVEN ON SITE. NO GUARANTEE IS GIVEN THAT ALL EXISTING SERVICES ARE SHOWN.

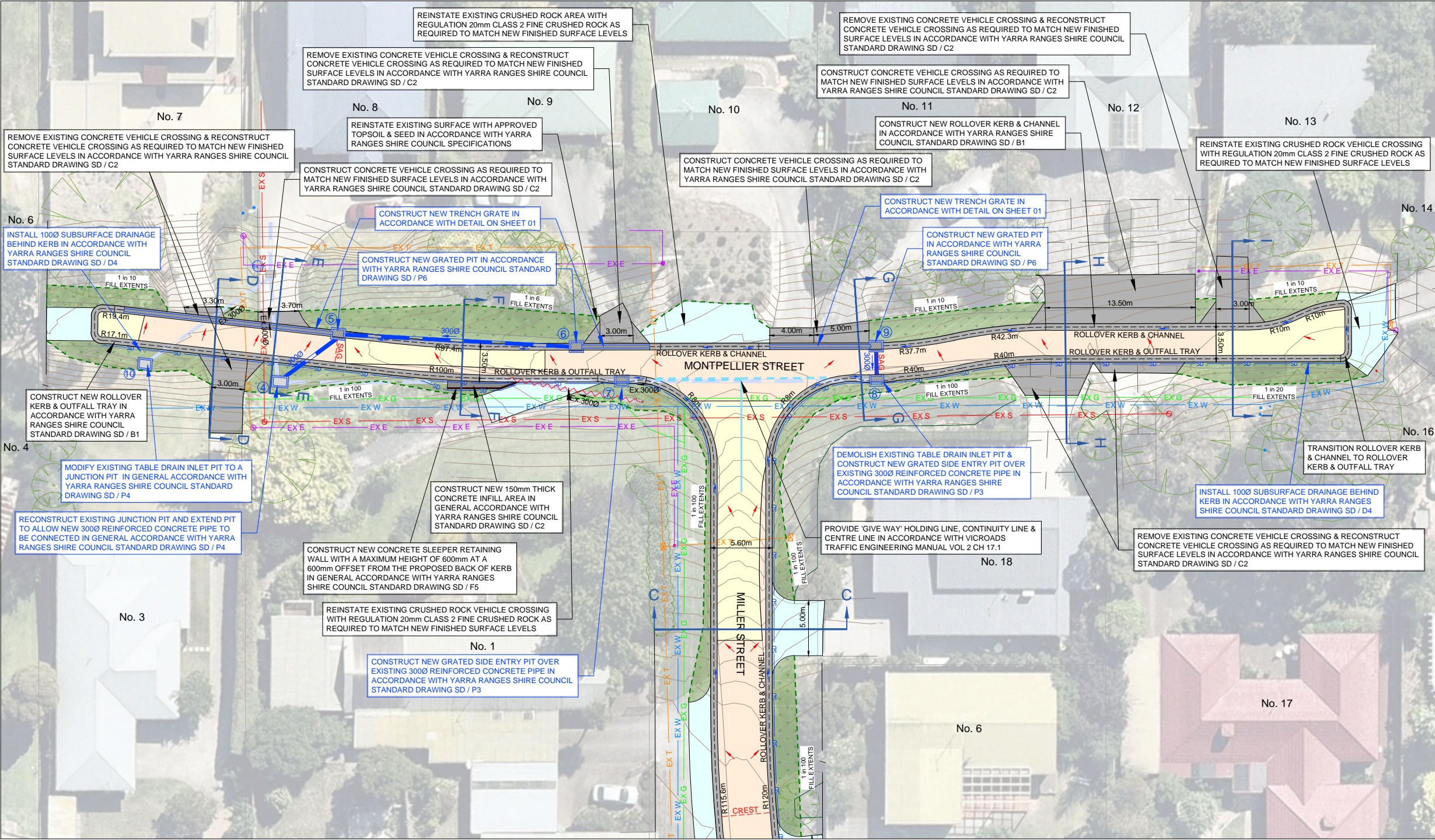

GENERAL LAYOUT PLAN

CONTINUED ON SHEET 05



02	FUNCTIONAL DESIGN - ISSUED FOR REVIEW	07-10-2021
01	FUNCTIONAL DESIGN - ISSUED FOR REVIEW	30-09-2021
00	FUNCTIONAL DESIGN - ISSUED FOR REVIEW	30-04-2021
VER	DESCRIPTION	DATE

CONSULTANT ENGINEER

PROCVIL

CONSULTING ENGINEERING

Specialist Civil Engineering Design Consultants

Commitment | Communication | Collaboration

PROCVIL CONSULTING PTY LTD

ABN 51 759 386 092

SUITE 9, 12 MAROONDHA HWY, RINGWOOD VIC 31134

PO BOX 164, RINGWOOD VIC 31134

P: (03) 8644 6834

E: info@procvil.com.au

www.procvil.com.au

CIVIL ENGINEERING DESIGN

KURT CHAMBERLAIN

REGISTERED & CHARTERED PROFESSIONAL ENGINEER

CHRIS PROCTOR

TECHNICAL PEER REVIEW

LUKE WHITFIELD

ORIENTATION

OR AS SHOWN

ORIGINAL SCALE & SHEET SIZE

AS SHOWN @ A1

HEIGHT DATUM

AHD

COORDINATE DATUM

MGA 94 ZONE 55

SURVEY DATE

18-09-2020

AERIAL IMAGE DATE

12-12-2020

LOCAL GOVERNMENT AREA

SHIRE OF YARRA RANGES

CLIENT

Yarra Ranges Council

CLIENT PROJECT MANAGER / CONTACT

PETROS INDOS | GRANT MCCARTHY

FUNCTIONAL DESIGN

ROAD & DRAINAGE RECONSTRUCTION WORKS

MILLER STREET & MONTPELLIER STREET, HEALESVILLE

GENERAL LAYOUT PLAN

PROJECT No.

PC20009B

SHEET No.

06 OF 08

VERSION

02

DWG No.

PC20009B - 06 - 02



WARNING
BEWARE OF UNDERGROUND SERVICES.
THE LOCATION OF EXISTING UNDERGROUND SERVICES ARE APPROXIMATE ONLY AND THEIR EXACT POSITION SHOULD BE PROVEN ON SITE. NO GUARANTEE IS GIVEN THAT ALL EXISTING SERVICES ARE SHOWN.

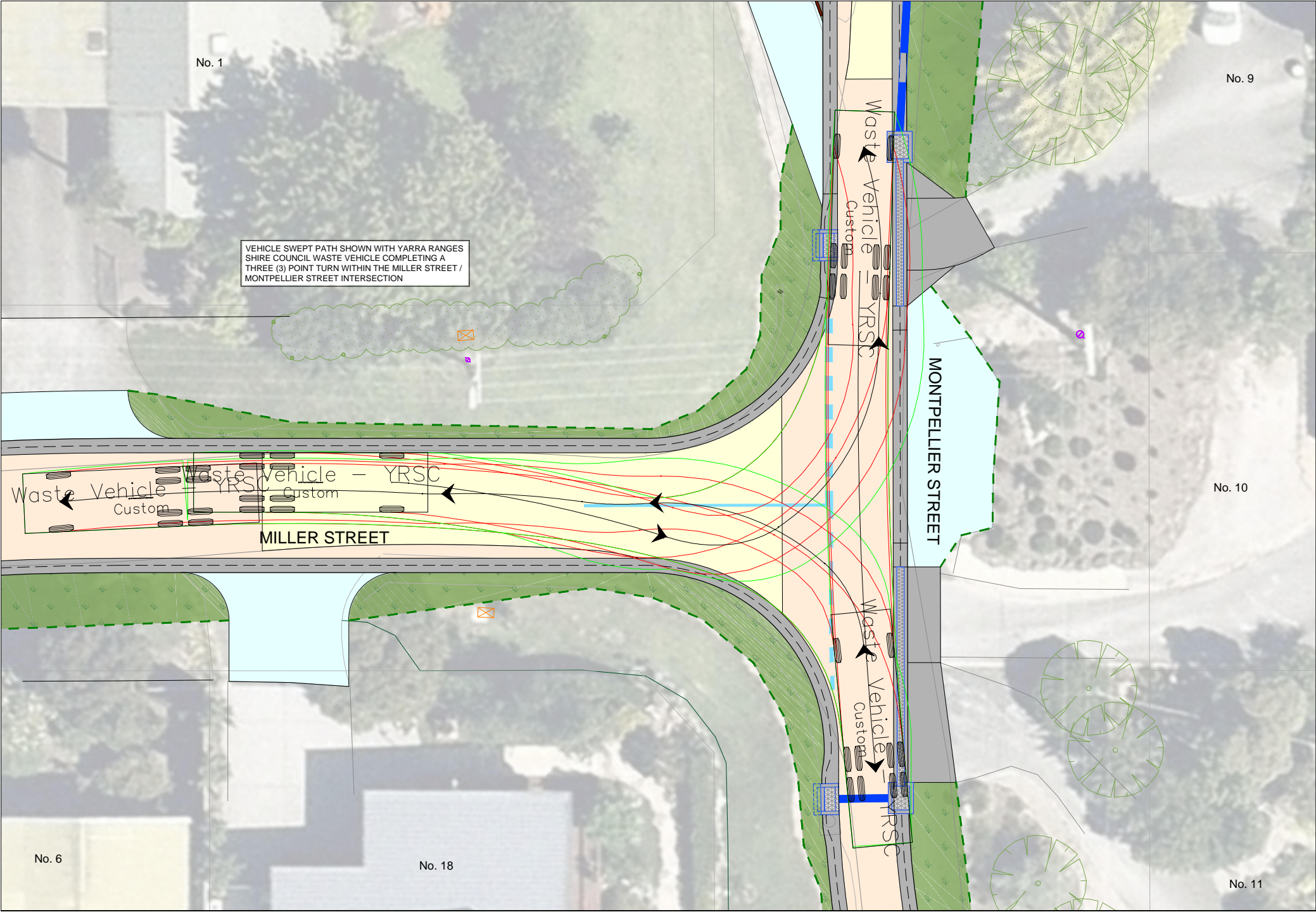
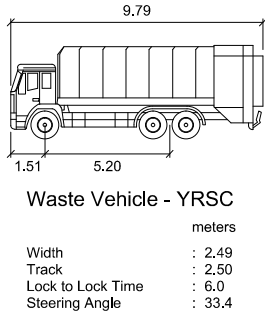
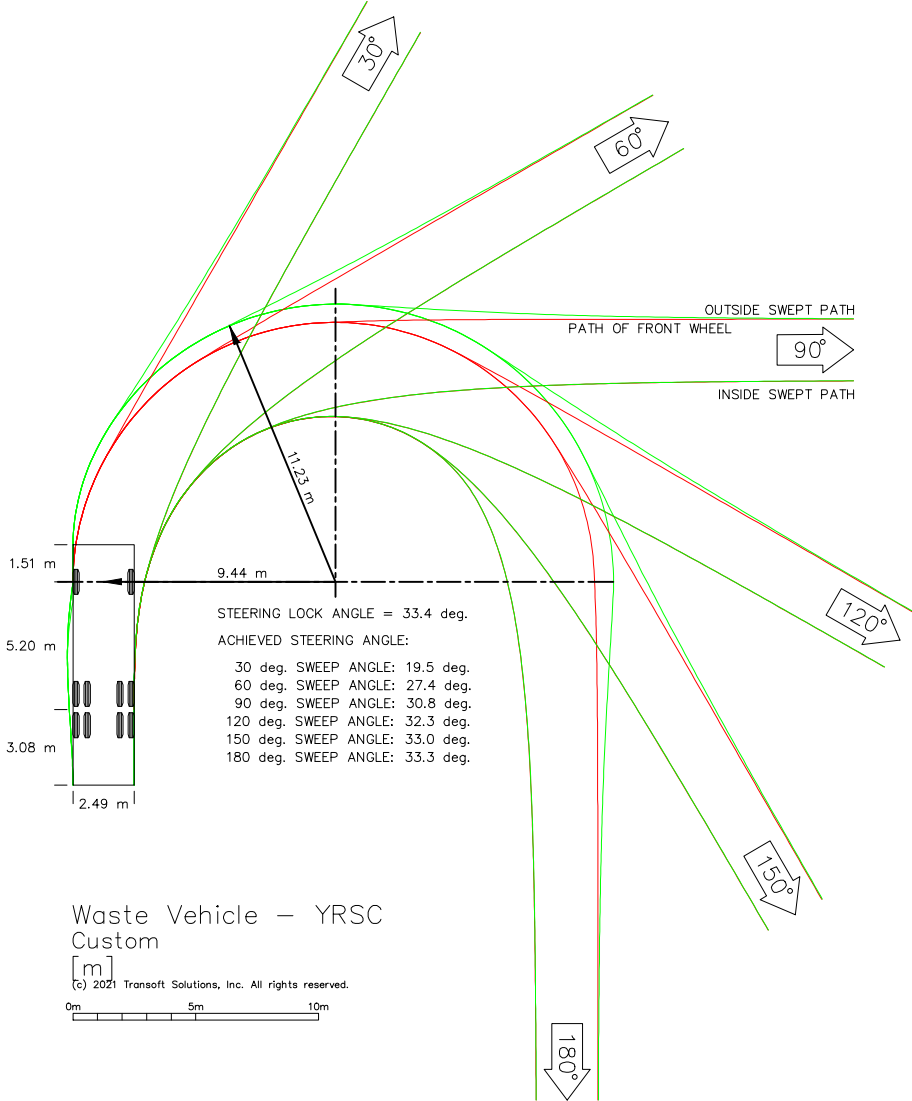

SWEPT PATH ANALYSIS PLAN - YRSC WASTE VEHICLE

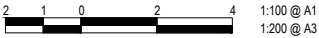

VER	DESCRIPTION	DATE
02	FUNCTIONAL DESIGN - ISSUED FOR REVIEW	07-10-2021
01	FUNCTIONAL DESIGN - ISSUED FOR REVIEW	30-09-2021
00	FUNCTIONAL DESIGN - ISSUED FOR REVIEW	30-04-2021

CONSULTANT ENGINEER

PROCIVIL
CONSULTING ENGINEERING

Specialist Civil Engineering Design Consultants

Commitment | Communication | Collaboration

PROCIVIL CONSULTING PTY LTD

ABN 51 759 386 082

SUITE 9, 12 MAROONDHA HWY, RINGWOOD VIC 3114

PO BOX 164, RINGWOOD VIC 3114

P: (03) 8644 6834

E: info@procivil.com.au

www.procivil.com.au

CIVIL ENGINEERING DESIGN

KURT CHAMBERLAIN

REGISTERED & CHARTERED PROFESSIONAL ENGINEER

CHRIS PROCTOR

TECHNICAL PEER REVIEW

LUKE WHITFIELD

ORIENTATION

OR AS SHOWN

ORIGINAL SCALE & SHEET SIZE

AS SHOWN @ A1

HEIGHT DATUM

AHD

COORDINATE DATUM

MGA 94 ZONE 55

SURVEY DATE

18-09-2020

AERIAL IMAGE DATE

12-12-2020

LOCAL GOVERNMENT AREA

SHIRE OF YARRA RANGES

CLIENT

CLIENT PROJECT MANAGER / CONTACT

PETROS INDOS | GRANT MCCARTHY

FUNCTIONAL DESIGN

ROAD & DRAINAGE RECONSTRUCTION WORKS

MILLER STREET & MONTPELLIER STREET, HEALESVILLE

SWEPT PATH ANALYSIS PLAN - YRSC WASTE VEHICLE

PROJECT No.

PC20009B

SHEET No.

07 OF 08

VERSION

02

DWG No.

PC20009B - 07 - 02



WARNING
BEWARE OF UNDERGROUND SERVICES.
THE LOCATION OF EXISTING UNDERGROUND SERVICES ARE APPROXIMATE ONLY AND THEIR EXACT POSITION SHOULD BE PROVEN ON SITE. NO GUARANTEE IS GIVEN THAT ALL EXISTING SERVICES ARE SHOWN.

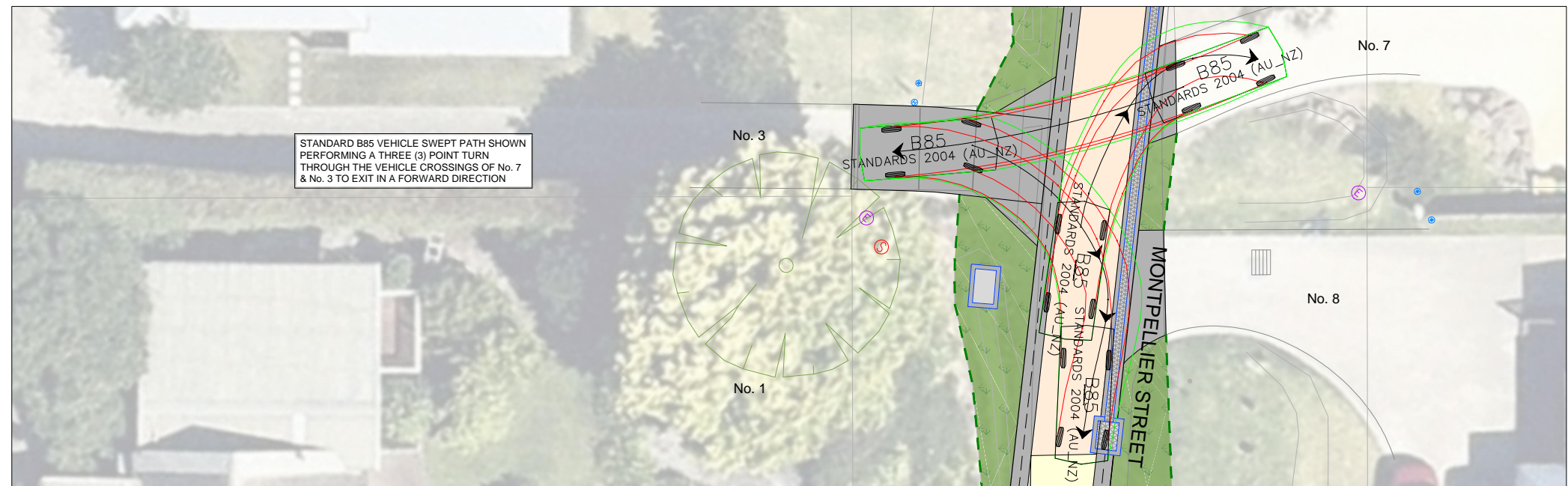
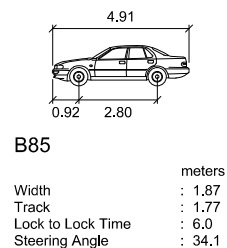
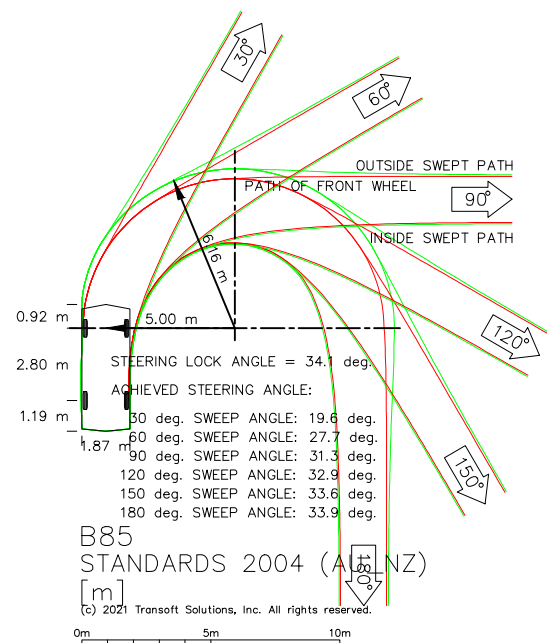

SWEPT PATH ANALYSIS PLAN - STANDARD B85 VEHICLE

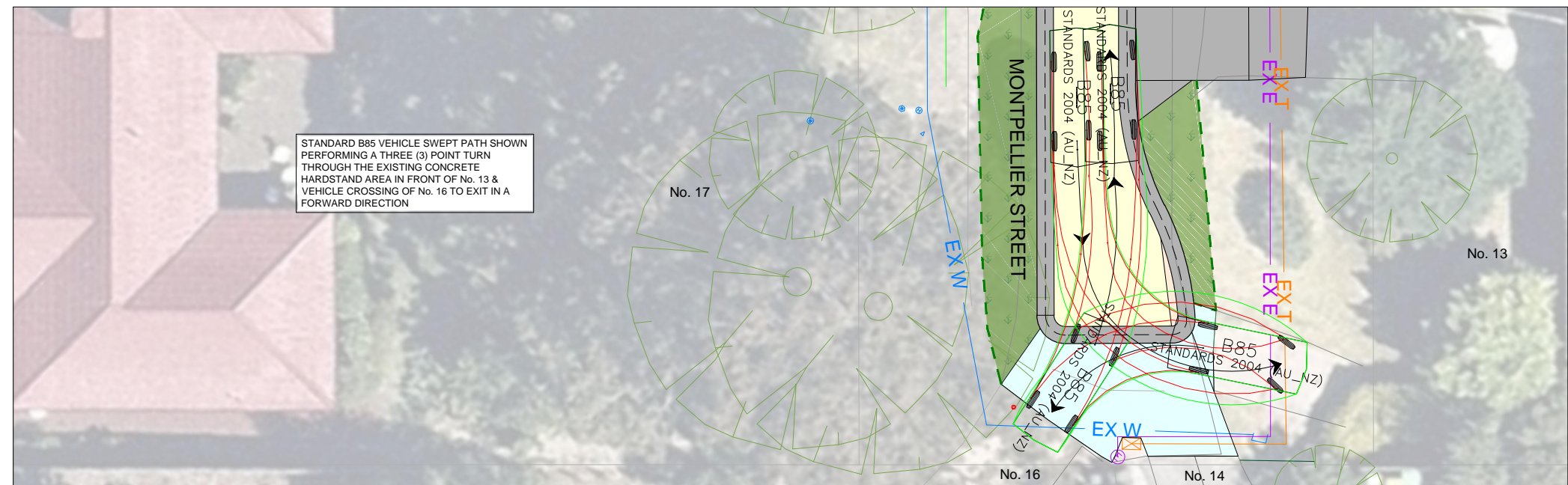
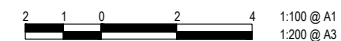

SWEPT PATH ANALYSIS PLAN - STANDARD B85 VEHICLE



		CONSULTANT ENGINEER		PROCIVIL CONSULTING ENGINEERING		PROCIVIL CONSULTING PTY LTD ABN 51 759 386 092 SUITE 9, 12 MAROONDAH HWY, RINGWOOD VIC 3134 PO BOX 164, RINGWOOD VIC 3134 P: (03) 8644 6834 E: info@procivil.com.au www.procivil.com.au		ORIENTATION		ORIGINAL SCALE & SHEET SIZE AS SHOWN @ A1		LOCAL GOVERNMENT AREA SHIRE OF YARRA RANGES		FUNCTIONAL DESIGN		PROJECT No. PC20009B	
				Specialist Civil Engineering Design Consultants		CIVIL ENGINEERING DESIGN KURT CHAMBERLAIN		TECHNICAL PEER REVIEW LUKE WHITFIELD		HEIGHT DATUM AHD		CLIENT Yarra Ranges Council		ROAD & DRAINAGE RECONSTRUCTION WORKS		SHEET No. 08 OF 08	
				Commitment Communication Collaboration		REGISTERED & CHARTERED PROFESSIONAL ENGINEER CHRIS PROCTOR		OR AS SHOWN		COORDINATE DATUM MGA 94 ZONE 55				MILLER STREET & MONTPELLIER STREET, HEALESVILLE		VERSION 02	
02 FUNCTIONAL DESIGN - ISSUED FOR REVIEW		07-10-2021								SURVEY DATE 18-09-2020						DWG No. PC20009B - 08 - 02	
01 FUNCTIONAL DESIGN - ISSUED FOR REVIEW		30-09-2021								AERIAL IMAGE DATE 12-12-2020							
00 FUNCTIONAL DESIGN - ISSUED FOR REVIEW		30-04-2021								CLIENT PROJECT MANAGER / CONTACT PETROS INDOS GRANT MCCARTHY							
VER DESCRIPTION		DATE												SWEPT PATH ANALYSIS PLAN - STANDARD B85 VEHICLE			